

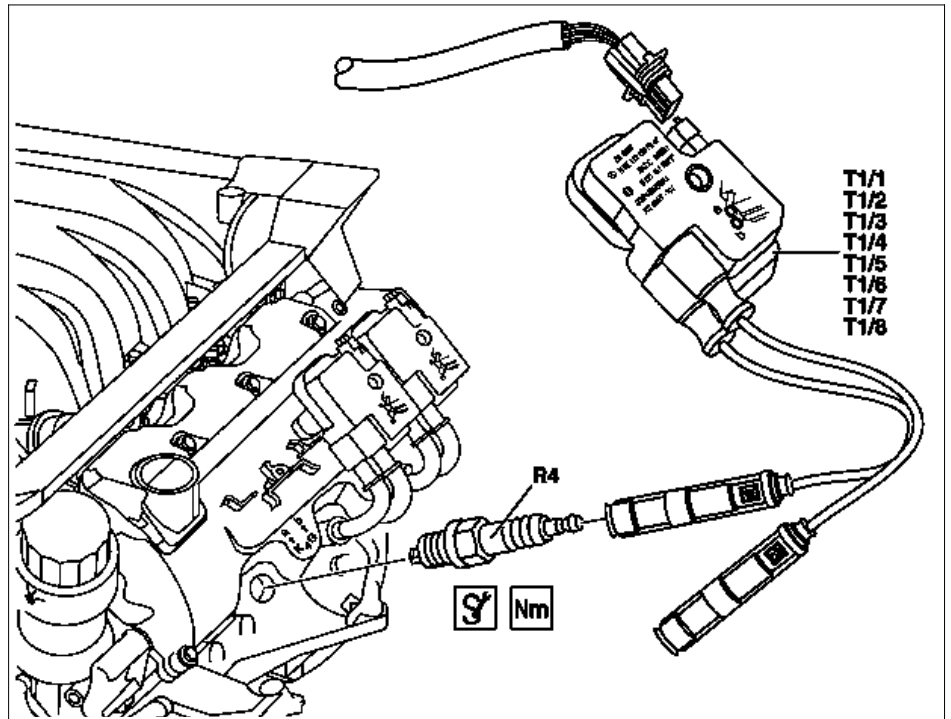

ENGINE 112.913 in MODELS 211.061 /261
ENGINE 112.949 in MODELS 211.065 /265
ENGINE 113.967 in MODELS 211.070 /270
ENGINE 113.990 in MODELS 211.076 /276
ENGINE 113.986 in MODEL 215.373
ENGINE 113.991 in MODEL 215.374
ENGINE 113.960 in MODEL 215.375, 220.875
ENGINE 112.922 in MODELS 220.063 /163
ENGINE 112.944 in MODELS 220.065 /165
ENGINE 112.972 in MODELS 220.067 /167
ENGINE 113.941 in MODELS 220.070 /170
ENGINE 113.986 in MODELS 220.073 /173
ENGINE 113.991 in MODELS 220.074 /174
ENGINE 113.960 in MODELS 220.075 /175
ENGINE 113.948 in MODELS 220.083 /183
ENGINE 113.966 in MODELS 220.084 /184
ENGINE 112.975 in MODELS 220.087 /187
ENGINE 112.973 in MODEL 230.467
ENGINE 113.992 in MODEL 230.474
ENGINE 113.963 in MODEL 230.475
ENGINE 112.917 in MODELS 211.080 /280
ENGINE 112.954 in MODELS 211.082 /282
ENGINE 113.969 in MODELS 211.083 /283
ENGINE 113.995 in MODEL 230.472

R4 Spark plugs
T1/1-
T1/8 Cylinder 1 ignition coil to cylinder 8
 ignition coil

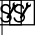

P15.10-2100-06

⚠	Remove/install and replacing		
⚠ Danger!	Risk of death caused by contact with parts conducting high voltages.	Do not touch parts which conduct high voltages. Persons who wear electronic implants (e.g. heart pacemakers) should never perform any work on the ignition system	AS15.10-Z-0001-01A
📖	Notes on avoiding damage to ignition system	Engine 104, 111, 112, 113, 119, 120, 271	AH15.10-P-0002-01D
1	Remove cover on face end of engine		
2	Remove air filter housing	i On model 220, 215 the air filter housing must be lifted off the support points of the cylinder head covers.	
🔧 AR	Remove/install air filter housing	Model 211.076/276, 215.374, 220.074/174, 230.472/474	AR09.10-P-1150SVK

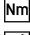
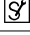
3	Remove cylinder 1 to 6 ignition coils (T1/1 to T1/6) or cylinder 1 to 8 ignition coils (T1/1 to T1/8) Remove/install ignition coils		AR	AR15.12-P-2003A
4	Pry spark plug connector off the spark plugs using open-end wrench, double above the cylinder head cover (R4)	 Double open-ended wrench		*110589010100
	 Checking			
5	Check spark plug connectors, ignition coil connectors and ignition lines for damage, deformation and crack formation	 Replace, if necessary.		
6	Remove spark plugs (R4)	  Spark plug wrench		*BA15.10-P-1001-01A *112589010900
7	Install in the reverse order			

 **Spark plugs**

Number	Designation	Engine	Engines	Engine
		104, 110, 111, 113.940/941/942/943/ 944/948/960/961/962/ 963/964/965/966/967/ 968/969/971/980/981/ 982/984/986/992/993/ 995, 115, 117, 119, 120	112.910/911/ 912/913/914/ 915/916/917/ 920/921/922/ 923/940/941/ 942/943/944/ 945/946/947/ 949/951/953/ 954/955/960/ 961/970/972/ 973/975/976	113.987/988/ 990/991
BA15.10-P-1001-01A	Spark plugs	Nm 28	28	25

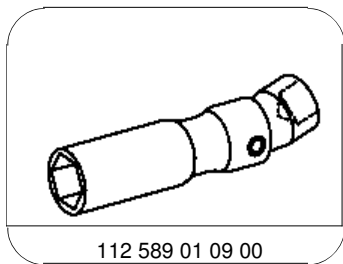

Spark plug wrench

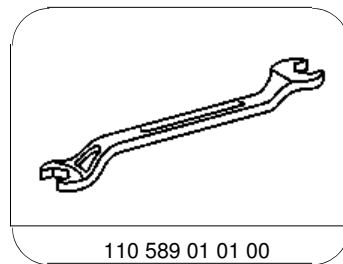

Open-end wrench, double